

# iMIX<sup>®</sup> Dispensers with 3 Hoppers

Seek eye catching powdered beverage dispenser featuring advanced mixing technology delivers exceptional hot drinks



**iMIX-3 PC**  
(Portion Control)



**iMIX-3S+**

## IMIX 3 FEATURES

- Three, 3.6 kg hoppers
- Lighted front graphics for merchandising.
- Large 16.66 litre hot water tank.
- Cup clearance of 18.4 cm.
- High speed, heavy-duty whipper for complete product mixing.
- Front of machine access for easy service, set up and calibration.
- Variable speed motors allow control of product consistency (.75 to 6.6 grams of powder per second).
- Low powder product detection system.\*\*
- Alphanumeric display in English and Spanish.\*
- Spring-loaded, all metal auger drive system for easy hopper installation.
- Auger motors with RPM feedback monitoring assure consistent flavours and profits by controlling powder dosing.\*\*

\*Available only on iMIX-3 and iMIX-3S+.

\*\*Available only on iMIX-3.

## IMIX-3S+ FEATURES

- Can be set as push and hold or single size portion control.
- Alphanumeric display allows adjustments and service operational testing from front of machine. Also communicates advertising messages, machine status and technical support contact information.

## RELATED PRODUCTS



**EQHP-10**  
Product No.: 39000.0004

**EQHP-10L**  
Product No.: 39000.0001

**Inlet Hose Assembly**  
Product No.: 32865.0001



**Chai Display**  
Product No.: 37457.0001



**Hot Chocolate Display**  
Product No.: 37457.0002



**Steamer Display**  
Product No.: 37457.0003



**Iced Cappuccino Display**  
Product No.: 37457.0006

## iMIX Dispensers with 3 Hoppers

Product #	Description	Shipping Weight	Electrical					Cord	Agency
			Volts	Amps	Watts	Hertz	Phase		
36900.0014	iMIX-3A, portion control	40.8 kg	230	15	3600	50	1	No	CE
36900.0027	iMIX-3B, portion control, non-lighted display		200	12.7	2530	50/60			CE
38600.0004	iMIX-3S+A, pushbutton		230	15	3600	50			CE

Plumbing: 138-624 kPa. Machine supplied with 1/4" male fitting. All plumbed models that are CE listed feature backflow prevention.

Dimensions in centimetres. Other models may be available, please contact your BUNN Sales Representative. For capacities, additional specs, manuals, care & cleaning, visit [www.bunn.com](http://www.bunn.com).

# iMIX<sup>®</sup> Dispensers with 4 and 5 Hoppers

Seek eye catching powdered beverage dispenser featuring advanced mixing technology delivers exceptional hot drinks



**iMIX-4**  
(portion control)



**iMIX-5S+**  
Silver Series

## IMIX-4 FEATURES

Includes all features below, and:

- Four, 3.6 kg hoppers
- Lighted front graphics for merchandising.
- Large 27.63 litre hot water tank.
- Cup clearance of 18.4 cm.
- Variable speed motors allow control of product consistency in mixing chamber (.75 to 6.6 grams of powder per second).
- High speed, heavy-duty whipper.
- Front of machine access for easy service, set up and calibration.
- Spring-loaded, all metal auger drive system for easy hopper installation.
- Low powder product detection system.
- Digital technology adds night mode to prevent pilferage.
- Alphanumeric display in English and Spanish.
- Auger motors with RPM feedback monitoring assure consistent flavors and profits by controlling powder dosing.
- Key service components easily accessible through front, top and side.

## IMIX-5S+ FEATURES

- Large 26.5 litre hot water tank.
- Can be set as push and hold or single size portion control.
- Digital technology adds night mode to prevent pilferage.
- Alphanumeric display in English and Spanish.

## RELATED PRODUCTS



**EQHP-10**  
Product No.: 39000.0004

**EQHP-10L**  
Product No.: 39000.0001

Product No.: 32865.0001



**Iced Cappuccino Display**  
Product No.: 36768.0005

## iMIX Dispensers with 4 or 5 Hoppers

Product #	Description	Shipping Weight	Electrical					Cord	Agency
			Volts	Amps	Watts	Hertz	Phase		
37000.0009	iMIX-4A, portion control	59.9 kg	230	15	3600	50	1	No	
38100.0005	iMIX-5S+A, pushbutton	60 kg	230		3600	50			

Plumbing: 138-621 kPa. Machine supplied with 1/4" male fitting. All plumbed models that are CE listed feature backflow prevention.

Dimensions in centimetres. Other models may be available, please contact your BUNN Sales Representative. For capacities, additional specs, manuals, care & cleaning, visit [www.bunn.com](http://www.bunn.com).

# Fresh Mix Dispensers with 1 and 2 Hoppers



FMD-1



FMD-2

## PRODUCT FEATURES

- Capacity:  
FMD-1: One, 3.6 kg hopper  
FMD-2: Two, 1.81 kg hoppers
- Variable speed hopper motor offers a wide range of product mix ratios (1.5 to 12 grams of powder per second).
- Lighted graphics merchandise drinks for maximizing profits.
- Large hot water reservoir provides 15.9 litre/hour serving capacity.
- Adjustable legs and drip tray allow up to 17.8 cm opening for serving cup.
- Specially designed mixing system delivers perfect beverages every time.
- Improved automatic rinse reduces run-on after beverage is dispensed.

## RELATED PRODUCTS



**EQHP-10**  
Product No.: 39000.0004

**EQHP-10L**  
Product No.: 39000.0001

**Inlet Hose Assembly**  
Product No.: 32865.0001

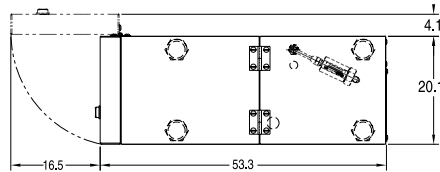

FMD-2

FMD-1

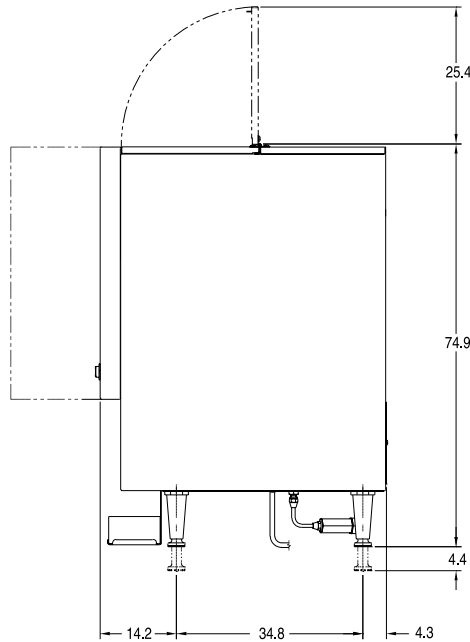
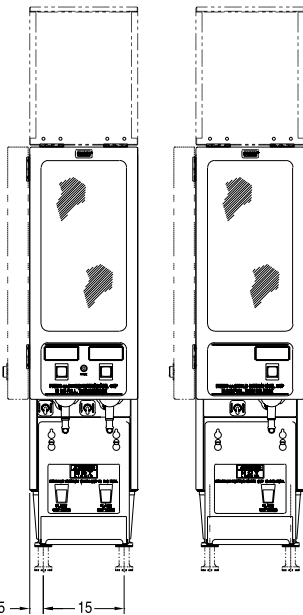

## Fresh Mix Dispensers

Product #	Description	Shipping Weight	Electrical					Cord	Agency
			Volts	Amps	Watts	Hertz	Phase		
SET00.0250	FMDA-1, black	34 kg	230	7.8	1800	50	1	Yes	CE
SET00.0252	FMDA-2, black	36.7 kg							

Plumbing: 138-690 kPa. Machine supplied with 1/4" male fitting. All plumbed models that are CE listed feature backflow prevention.

# Fresh Mix Dispensers with 3 Hoppers



FMD-3 DBC



FMD-3

## PRODUCT FEATURES

- Three 1.81 kg hoppers.
- Variable speed hopper motors offer control of product consistency.
- Lighted graphics for merchants.
- Adjustable legs and drip tray allow up to 17.8 cm opening for serving cup.
- Specially designed mixing system delivers perfect beverages every time.
- Improved automatic rinse reduces run-on after beverage is dispensed.

## FMD DBC DISPENSER FEATURES

- Easy-to-program, one-touch portion control for three cup sizes.
- Fast fill - perfect for quick service applications.
- Each mixing chamber has independent powder to water ratio.
- System setup is password protected for safety and security.
- Simple setup and hopper throw calibration system.
- Hot water dispense.

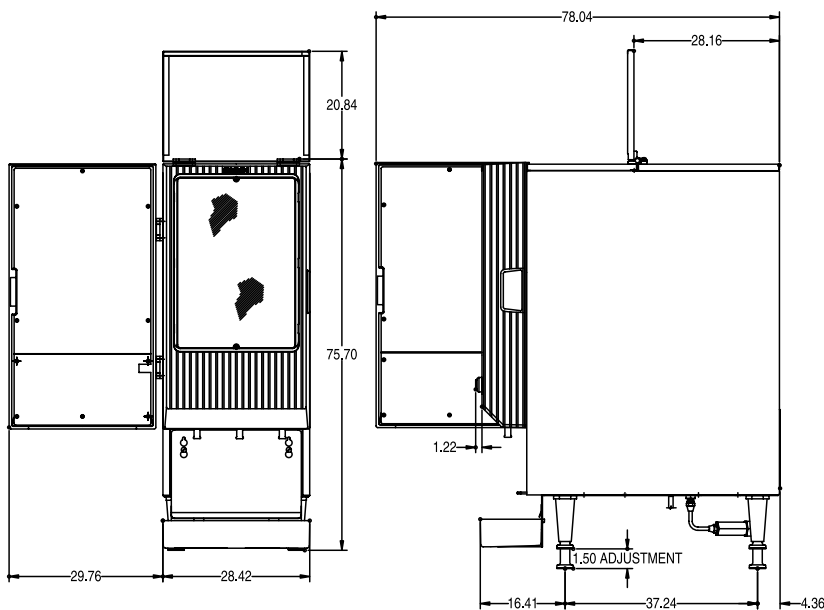

## RELATED PRODUCTS



**EQHP-10**  
Product No.: 39000.0004

**EQHP-10L**  
Product No.: 39000.0001

**Inlet Hose Assembly**  
Product No.: 32865.0001

## Fresh Mix Dispensers

Product #	Description	Shipping Weight	Electrical					Cord	Agency
			Volts	Amps	Watts	Hertz	Phase		
28200.0048	FMDA-3, stainless steel	39.9 kg	230	15	3600	50/60	1	Yes	
29250.0010	FMDA-3 DBC, hot water dispense	39.9 kg	230		3600	50/60			
SET00.0174	FMDA-3 DBC, hot water disp., German literature								

Plumbing: 138-621 kPa. Machine supplied with 1/4" male fitting. All plumbed models that are CE listed feature backflow prevention.

# Fresh Mix Dispensers with 5 Hoppers



FMD-5

## PRODUCT FEATURES

- Five 1.81 kg hoppers.
- Variable speed hopper motors offer a wide range of product mix ratios (1.5 to 12 grams of powder per second).
- Lighted graphics.
- Adjustable legs and drip tray allow up to 17.8 cm opening for serving cup.
- Specially designed mixing system delivers perfect beverages every time.
- Improved automatic rinse reduces run-on after beverage is dispensed.
- Electrical and plumbing components easily accessible through front and top.

## RELATED PRODUCTS



**EQHP-10**  
Product No.: 39000.0004

**EQHP-10L**  
Product No.: 39000.0001

**Inlet Hose Assembly**  
Product No.: 32865.0002

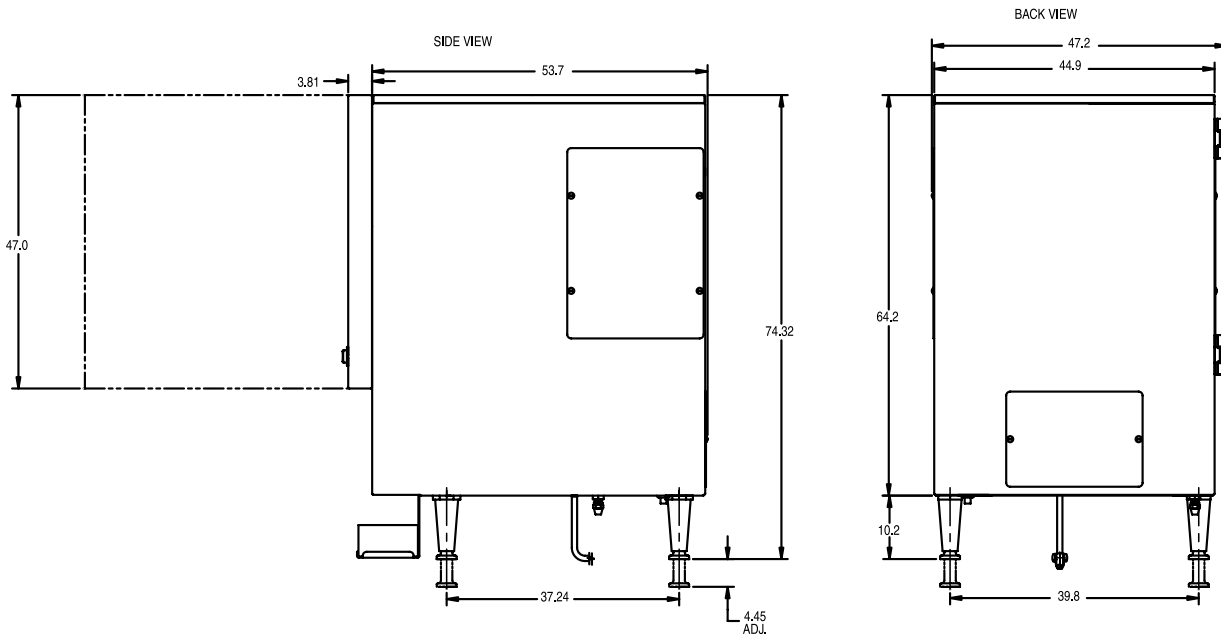

Fresh Mix Dispensers									
Product #	Description	Shipping Weight	Electrical					Cord	Agency
			Volts	Amps	Watts	Hertz	Phase		
34900.0010	FMD-5A, push-hold	53.5 kg	230	15	3600	50/60	1	Yes	CE

Plumbing: 138-621 kPa. Machine supplied with 3/8" male fitting. All plumbed models that are CE listed feature backflow prevention.